

INSIDE...

Protections from
the Failure of
Other Contractors:
Maintain
Security Rights

 **construction**resource



*How are you addressing the
Workforce Shortage?*

PUBLISHED QUARTERLY BY



New Hampshire/
Vermont Chapter

VOLUME 27
ISSUE 1

*When it comes to
fire protection, go with
the largest in N.H.*



Hampshire

FIRE PROTECTION Co., LLC

ALL TYPES OF FIRE PROTECTION

FIRE SPRINKLERS • FIRE ALARMS

FOAM • FIRE EXTINGUISHERS

SALES • DESIGN • INSTALLATION • INSPECTIONS

**COMMERCIAL • INDUSTRIAL
SERVICE • REPAIR**



8 No. Wentworth Ave.
Londonderry, NH 03053
603.432.8221
603.434.3194 (f)

55 Harvey Road
Londonderry, NH 03053
603.432.8221
603.434.8128 (f)

104 Etna Road
Lebanon, NH 03766
603.448.5461
603.448.7334 (f)

277 Old Homestead Hwy
Swanzey, NH 03446
(603) 358-6736
(603) 358-6832 (f)

PO Box 53
Jackson, NH 03846
(603) 383-6888
(603) 383-6888 (f)



www.hampshirefire.com



**New Hampshire/
Vermont Chapter**

Associated Builders and Contractors, Inc. is a national non-profit organization whose mission is to represent the construction industry as a cohesive group of professionals, to serve as their vision and voice, and to pursue quality, common goals, and solutions to industry issues.

The NH/VT chapter is located at:
58 Chenell Drive, Concord, NH
603-226-4789
info@abcnhvt.org

Construction Resource is published quarterly by the NH/VT Chapter of Associated Builders and Contractors. Subscription rate is \$20 per year.

CHAIR

Wayne Symonds, Methuen Construction Co., Inc.

1ST VICE CHAIR

Joe Campbell, North Branch Construction, Inc.

2ND VICE CHAIR

Will Long, Interstate Electrical Services Corp.

TREASURER

Rusty Mosca, Nathan Wechsler & Co., CPA

DIRECTORS

Tim Barton, DECCO, Inc.
Sarah Crane, Andrews Construction Co., Inc.
Bill Hickey, The H.L. Turner Group Inc.
Robert Holden, Denron Plumbing & HVAC, LLC
Eric Horner, The Rowley Agency
Matt Johnson, Devine, Millimet & Branch
Jeff Luter, Fulcrum Associates, Inc.
Dan Smith, H.P. Cummings
Construction Company
Matt Wheaton, The MacMillin Company

PAST CHAIR

Mike Dion, Metro Walls, Inc.

NATIONAL DIRECTORS

Kelly Gagliuso, Gagliuso & Gagliuso, PA
Mark Hodsdon, Palmer & Sicard, Inc.

EX OFFICIO:

Jennifer Monkiewicz, USI Insurance,
ABC Group Trust Administrator
Jeff Comeau, Specialty Services of New England,
LLC, ABC Young Professionals Group (YPG), Chair

PRESIDENT

Joshua P. Reap, ABC NH/VT

DIRECTOR OF LEARNING & DEVELOPMENT

Jennifer Landon, ABC NH/VT

DIRECTOR OF PROGRAM MANAGEMENT

Paulette Melanson, ABC NH/VT

DESIGN/PRODUCTION

Susan G. Englert
Bradstreet Englert Creative
www.BECreativeSC.com

Table of Contents



FROM THE CHAIR

Reflections on the Past –
Goals for the Future 3

WORKFORCE DEVELOPMENT

How Are You Addressing
the Workforce Shortage? 5



IMPORTANT INSIGHT

Protections From the Failure
of Other Contractors:
Maintain Security Rights..... 9



HUMAN RESOURCES

Five Strategies to Deal With
Opioid Dependence and Substance
Abuse in Construction 13



MEMBER NEWS

News of Our Members..... 19
New Member Spotlight..... 27
ABC NH/VT Annual Excellence
In Construction Awards..... 28



PROFESSIONAL RESOURCES 20-21

ADVERTISER INDEX 40

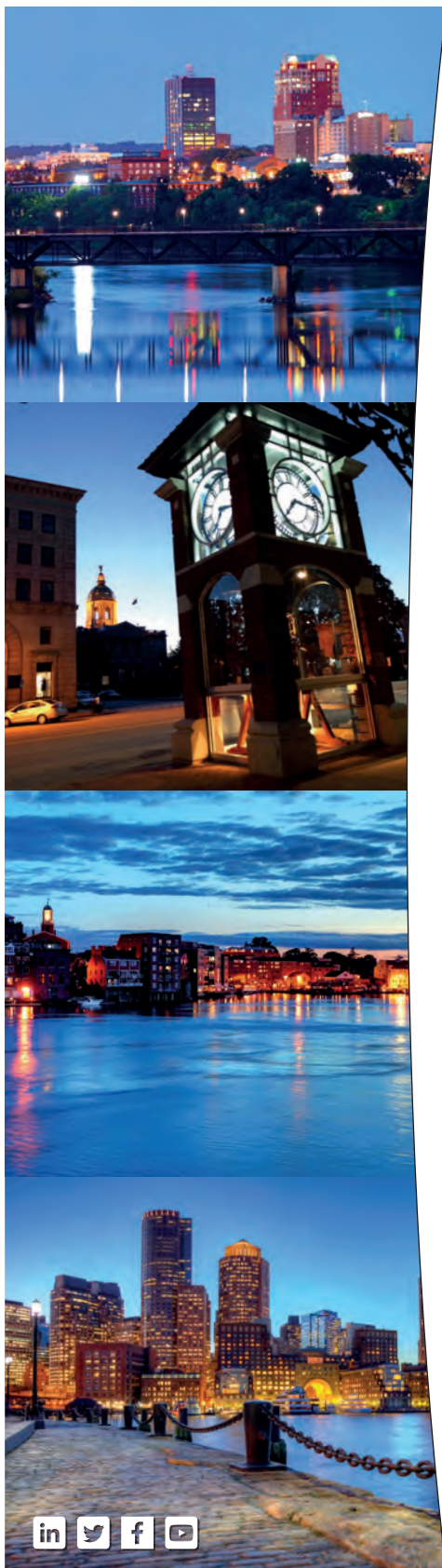

Devine Millimet's Construction Team has the technical training and industry experience necessary to represent clients on complex projects throughout New England and beyond.

How can we help you?

**DEVINE
MILLIMET**

ATTORNEYS AT LAW

MANCHESTER
CONCORD
PORTSMOUTH
BOSTON
603-669-1000
DevineMillimet.com

DevineMillimet.com/Construction



Reflections on the Past – Goals for the Future

Every New Year is the time to reflect on our accomplishments from the last and recognize the many achievements by the ABC staff, the out-going president, and our chapter chair.



tion committee to hire a highly qualified replacement for our long-term president Mark Holden. Mike has tirelessly taken an active role in promoting our future through the YPG and protect-

The Chapter is embarking on a fresh start with the transition of Presidents. Mark Holden has moved on to a well-earned retirement, which was preceded by building one of the most respected associations in the region. Mark consistently kept focus on the predominant issues facing our industry over the last 33 years. Our 2017 chapter chairman, Mike Dion provided leadership and guidance that facilitated the transi-

ing the Merit Shop way through his advocacy. Our chapter staff did not miss a beat through the transition despite the demands of training, membership growth, event planning, and workforce development.

It is important to acknowledge the challenges the industry has experienced over the last decade. Although some of the challenges remain constant, we are faced with the most extraordinary challenge of de-

veloping tomorrow's future for our industry.

The leadership of the NH/VT ABC Chapter must consistently stay focused on goals, follow up on progress, and pursue results. As an association we must remain relevant to the priority issues at hand for our industry. During our planning session we revisited 2017 goals for the association and our progress. We also established new goals and objectives to be implemented over the course of 2018. Three focus areas were prioritized for 2018, which include workforce development, political advocacy, and membership growth. Each focus area will have a Board Member Champion that will work with ABC staff and membership to advance these goals.

Now is the time to invest in workforce development -the industry needs a culture change.

Investing in our teammates is a recruitment tool, a retention tool, and a requirement in order for our businesses to remain viable. Workforce development(WFD) is a widely used term that encompasses both those activities that encourage students in elementary, middle, and high school to consider the potential of a career in construction. We need more mentors to help prepare young people for their first jobs in the industry.

In order to accomplish this as an industry, we must establish ABC NH/VT the "leading" resource for industry training and WFD needs. Some of the initiatives we will advance this year include: the creation a Member Advocate Program with high schools, technical schools and expansion of the

chapter's training programs to better support skilled trade development. The ABC chapter's bottom line, the establishment of a 501(c)3 as a vehicle for the intake of training grants and donations as well as the creation of a "Trades Bootcamp" will all help in our mission to develop a bigger workforce. We need the utilization of YPG and other similar organizations to work collaboratively as a vehicle to develop the industry future leaders.

Political advocacy is key to supporting our number one priority of workforce development. Our chapter president will identify and establish a working relationship with influential legislative contacts to promote legislation that supports the ABC mission, the development and support of policy positions on key issues in New Hampshire and Vermont.

Last and equally as important, robust membership growth will support priority one for our association as chapter growth will facilitate outreach with high schools, CTE's, and especially with parents.

I am honored, humbled and very proud to have the opportunity to serve our industry and most importantly work on behalf of our members.

Wayne Symonds

ABC NH/VT Chairman 2018

**CONSTRUX,
INC.**

METAL BUILDINGS

New England's
Award Winning
Metal Building
Expert since
1987

- **Designed**
- **Supplied**
- **Erected**

30

Years of
Service

www.construxinc.com



*Who has the lowest workers' comp costs in
New Hampshire?*



**MEMBERS OF THE
ABC SELF-INSURED
GROUP TRUST**
for Workers' Compensation

Jennifer Monkiewicz, Vice President/Administrator
ABC Self-Insured Group Trust

We manage the risk...

- Regulated by the Department of Labor
- Audited by an independent accountant firm
- Allow in only the best of the best
- A-Rated reinsurance carrier caps group's losses
- Focus on loss prevention and claims management
- Monitor members to ensure strong performance
- Strong management by member board of directors

Take Control - Our Members Have...

- .85 Average Experience Modification
- 30% Average Five Year Loss Ratio
- \$2.6 million in cash back to our members for good performance in the last 4 years alone.
- Every member receives free loss control hours plus resources to maintain safety
- Consistency and Stability
- Aggressive Claims Management leading to 20% savings in claims costs



For more information, call 603-226-4789 or email info@abcnhvt.org



How Are You Addressing the Workforce Shortage?

The nation's construction industry is facing a crisis today.

In New Hampshire the construction unemployment rate is around 2.9% and has remained below 3% for over a year. As an industry, we have a gray and graying workforce, with the average age of a worker hovering around 50. These factors combine to create a challenge for an industry experiencing rapid growth which keeps it from being able to address the issue of workforce development.

Judging by the amount of work

experienced rapid growth in the demand for education and ABC delivered high quality training that exceeded the expectations of our members across the chapter. As a chapter we are proud to help contractors invest in their people, which led to winning more work and the delivery of that work for the betterment of communities across New England.

Not only have we seen a demand for more education and safety training, but ABC has also provided training, such as

Year-over-Year CBI Map of Regions and Backlog Months
Third Quarter 2016 v. Third Quarter 2017

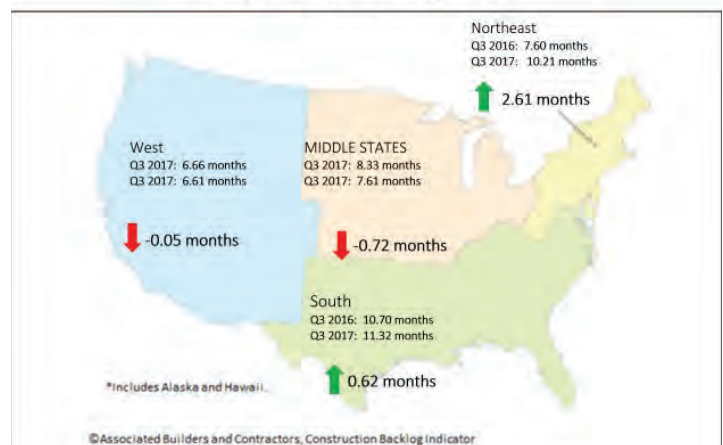

on the books, the problem is going to be long term as the Construction Backlog Indicator current sits at 10 months in the Northeast.

Workforce Development Efforts

ABC is a lead partner in construction workforce development. Last year ABC and its members invested \$1.1 billion in workforce training. That amounted to 476,000 people trained across America. In New Hampshire and Vermont, we

the very popular Future Leaders in Construction (FLiC) program and our Super Cert programs. These classes made for a good year in 2017 and we anticipate that 2018 will be even greater.

Creating Opportunity

There are limitless opportunities to build the American workforce through government-defined and industry workforce development programs. Innovative and unique platforms can

WORKFORCE TO PAGE 6

SLCHASSESTEEL



STRUCTURAL STEEL
MISCELLANEOUS METALS
FABRICATION
ERECTION



8 CHRISTINE DRIVE, HUDSON, NH 03051
PH: (603) 886-3436 • FAX: (603) 881-9953

QUALITY WORKMANSHIP AND EXPERIENCE
COMPETITIVE PRICE
IN-HOUSE DETAILING STAFF
UTILIZING SDS/2 SOFTWARE



WWW.SLCHASSESTEELFAB.COM
EMAIL: INFO@SLCHASSESTEELFAB.COM

PROUD MEMBERS OF:







What you don't know can hurt you.



SAVE YOUR PROJECT FROM THE HASSLES OF FINDING THE UNEXPECTED.

There's no time to waste.
RPF Environmental is a full-service environmental health and safety consulting and testing provider that responds with the most cost-effective and quickest turnaround in the industry.



RPF Environmental
RAPID RESPONSE. TRUSTED RESULTS.

Schedule a consultation today.
1-888-SAFE-AIR • Or visit www.airpf.com.

WORKFORCE, FROM PAGE 5

provide the way for all Americans to develop skills to achieve their dreams.

However, with an aging workforce and an insufficient pipeline of new workers, the construction industry faces a critical shortage of skilled craft professionals. According to economic data, approximately 500,000 construction jobs are ready to be filled right now, and that number will increase with economic growth and forthcoming federal infrastructure legislation.

In 2018 the ABC New Hampshire/Vermont Chapter is engaged with sector partners across the region to address the problem locally. We find our-

curricula and industry-recognized, portable credentials for more than 70 crafts that have been used in all 50 states and in 20 countries. Though it was relatively unknown in New Hampshire and Vermont, that is beginning to change.

Everyday more stakeholders are coming to know and use NCCER because it is flexible and affordable. It is proven to get people ready for the workforce and is a valuable tool more employers should use when training their workforce. To learn more, you can visit www.NCCER.org.

At ABC, we believe in building people through the merit shop philosophy: that projects and personal advancement should be awarded based on

“Leadership is not about finding the fault with others, it’s more about learning about yourself and looking inward. When I first came to this program I thought it was going to be about how to manage people. I quickly found out that it is more about learning who I am. What are my strengths, weaknesses and areas that I need to work on? In this way I can be a more effective leader.”

- FLiC 2017 Graduate

selves serving as the nexus that has brought together contractors, career and technical education high schools, colleges and even middle schools.

Credentialed Training

Portable, credentialed programming is an important component to solving the workforce shortage. Founded in 1991 by ABC and leading contractors, NCCER is the industry’s source for craft training, assessment and certification. Today, NCCER develops standardized

performance, skill and achievement. ABC has been setting the standard for safety, quality and integrity in the construction industry since 1950 and will continue doing so well into the future.

To become involved in our workforce development initiative, contact our office today by calling (603) 226-4789.



ABC New Hampshire/
Vermont Chapter

Education by the Numbers

Total Participants
in 2017 ABC trainings: **912**

40% increase from 2016

20% more classes in 2017

500,000 JOBS
ARE READY TO BE FILLED RIGHT NOW
in the American construction industry

ABC'S ANNUAL IMPACT:

\$1.1 BILLION

INVESTED BY ABC MEMBERS
IN WORKFORCE TRAINING



476,000

PEOPLE TRAINED

PAGE STREET
Storage
LEASING LLC

**On-Site Storage Solutions
Prompt & Professional
Service To Your Job Site.**



10' • 20' • 40'

Storage Containers



27'-53' Trailers

& 45'-48' Flatbeds



**Ground-Level Offices
Now Available**

Rent or Purchase • Short-Term & Long-Term

Serving NH • MA • ME • VT For Over 30 Years

We Accept



603-622-1673

www.pagest.com



603.527.0101

www.MeridianNH.com



Industrial Projects

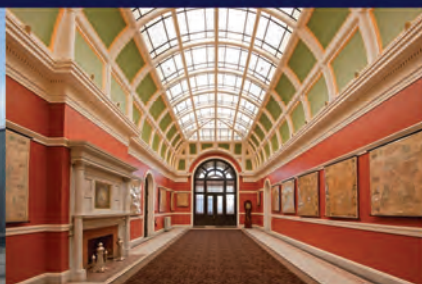

Historical Renovations



Public & Private Schools



Commercial Construction



Commercial Steel Buildings



Athletic Centers



Custom Construction



Residential Building



Office & Warehouse

From the precision of industrial projects to the fine finishes of custom construction, we honor your commitment to finding the highest quality in building excellence and pledge a strong partnership with every project we engage.

General Contractors
Construction Managers
Design / Builders





Protections From the Failure of Other Contractors: Maintain Security Rights

BY NATE BUDDÉ

The construction industry is overly burdened by contractor failures. In fact, construction routinely leads all other industries in failure rates. The construction industry seems to present a perfect storm for driving up failure rates: razor-thin margins, significant cash demands, payment timing issues necessitating large “floats” of costs, and more all add up to a large number of failures. And, since the construction payment chain is so interconnected, a failure by any project participant can be felt up and down the payment chain – and even on other projects.

It doesn't have to be this way. Construction companies all benefit from strong statutory protections built into the laws of every state. These protections, when used appropriately, can shield a company from the failure of other contractors and – as an added bonus – make sure payment is made more quickly.

The best way to protect against the financial risks associated with contractor failure is two-pronged:

- understanding and avoiding internal factors or practices that put the business at risk; and
- preparing for and protecting against the mistakes and failures of other parties.

Internal protections: know and prevent the leading factors that cause contractor failure

There is a lot of data on the propensity of contractors to close up shop, and much of it details relatively common practices that just take a disciplined approach to avoid. Contractors of all tiers must understand these common risk factors and risky behaviors in order to avoid becoming an unfortunate statistic. Cash flow is one of the most common triggers for contractor failures. This is due in no small part to the nature of construction payment itself. Paying suppliers' invoices with short payment terms and making sure payroll is met can cause severe strain on a company that is waiting for payment for work already performed on multiple jobs. And, taking on more work to increase revenue can exacerbate these problems in the short run. The construction industry is always cash hungry, but it helps to take a moment to consider that more business requires more cash – so the dangers of too much potential business can be just as devastating as the problems of too little.

In order to best protect the company from these cash risks, the following steps should be taken:

- get financial documents in order and make cash projections each month; use these projections to guide the company as to which projects to accept, and which to discard;

- always plan ahead to secure cash financing and availability before the company gets desperate;
- don't get greedy and take on too much work (compared to cash reserves and ability to navigate floating significant associated costs related to potential slow payment);
- be careful with bids and estimates, and don't promise to do projects for too low a fee, relying on good luck or change orders to make up for unexpected costs; and
- take steps to improve the timing of payments by providing notices and remaining in a secure position.

External protections: prepare for and protect against the mistakes and failures of other parties

Understanding the default risks and taking proactive steps to keep a company healthy is only one part of the equation. By itself, though, it is not enough. Exercising extraordinary discipline and good cash management practices is a crucial part of avoiding failure, but even a carefully constructed protection wall can come crashing down like a house of cards due to the poor practices of other companies on a project. Diligent cash management is only part of the necessary story.

The web of construction payment means that one company's default, delay or poor workmanship on a project – no

commercial • industrial • institutional • design/build • residential

STEEL FABRICATORS

Structural Steel, Metal Pan Stairs, Fire Escapes, Spiral Stairs, Interior & Exterior Railings in Steel, Aluminum, Stainless Steel, Bronze, or Specialty Cable Rails. We also custom fabricate a wide variety of miscellaneous steel components.

www.multi-weld.com

The Strength of Steel. The Quality of Multi-Weld.
Since 1986

MULTI-WELD

MWS

services

INCORPORATED

Contoocook, New Hampshire

Give us a call! 603.746.4604



2018 ABC Premier Sponsors

Platinum Sponsors

EnviroVantage
 ASBESTOS ABATEMENT. REMEDIATION. DEMOLITION. .com
 www.EnviroVantage.com • 800-640-5323 • info@envirovantage.com
 Locations in New Hampshire, Massachusetts and Maine

METRO Walls

CROSS
 INSURANCE
 WHERE SECURITY MEETS STRENGTH

THE ROWLEY AGENCY
 INC.
 INSURANCE • BONDS • BENEFITS
 ...an Assurex Global Partner



Nathan Wechsler
 Accountants & Business Advisors

Gold Sponsors

ABC
 New Hampshire
 Self Insurance Group
 TAKING CHARGE OF WORKERS' COMPENSATION

North Branch
 Construction

Fulcrum

DEVINE
 MILLIMET

ATTORNEYS AT LAW

MERIDIAN
 construction

SERVICE[®]
 CREDIT UNION



MCMethuen
 CONSTRUCTION



RIGHTS, FROM PAGE 9

matter where that company is on the contracting chain – can cause problems for everyone, so it's equally critical to prepare for everyone else's cash management to be a mess.

While there are numerous methods (of differing effectiveness) to protect against other parties' failures, by far the most effective is to always protect mechanics lien and bond claim rights. Mechanics liens give a contractor an interest in the improved property itself and enable the contractor to skip right past the defaulting contractor to seek payment directly from another interested party, including the prime contractor or property owner. It even allows the contractor to actually foreclose on the

property itself in order to get paid. If a customer is having cash problems or is slow to pay, these security instruments can be incredible tools, and the

... the process of informing all parties up the chain that the company is on the project, when otherwise they may not know, and that the company's rights are protected, puts the company at the front of the line for payment and prioritizes payment over others if money gets tight.

difference between a write off and cash in hand.

Further, the process of informing all parties up the chain that the company is on the project, when otherwise they may not know, and that the company's rights are protected, puts the company at the front of the line for payment and prioritizes payment over others if money gets tight. Providing notice, which is generally required to maintain these security rights, makes a company visible and opens up an avenue for communication and dialogue between parties. The mere act of having a forum for discussion available can help a contractor avoid many payment disputes or other sticky payment issues.

Construction is a tough business, but following the steps outlined above can make the difference between success

or adding to the pile of contractor failures.

Nate Budde is the chief legal officer and general counsel at zlien, a nationwide mechanics lien service to help contractors reduce their credit risk through the management of mechanics lien and bond claim compliance. He is a licensed attorney in Louisiana and a graduate of Stanford University (B.A.) and Tulane Law School (J.D.).

Reprinted from constructionexec.com, Feb. 21, 2018, a publication of Associated Builders and Contractors. Copyright 2018. All rights reserved.



Design it. Plan it. Build it.

Delivering Insurance Solutions for Your Business.

USI Insurance Services LLC
3 Executive Park Drive, Suite 300
Bedford, NH 03110
Toll Free: 855-USI-0123 | usi.com



Equipment | General Liability | Auto | Workers' Compensation
Surety | Contract Review | Claims/LossControl

Copyright ©2016 USI Insurance Services LLC. All Rights Reserved.

Tilton Trailer Rental
SPECIALIZING IN STORAGE CONTAINERS & OFFICE TRAILERS
Serving the Tri State Area for over 25 years

BEST RATES - QUICK DELIVERY - PURCHASE OPTIONS

MOBILE AND ON-SITE STORAGE CONTAINERS

28'-53' BOX TRAILERS

20' & 40' STORAGE CONTAINERS

20' & 40' OFFICE CONTAINERS

20' TO 60' OFFICE TRAILERS

ON-SITE STORAGE AVAILABLE
505 WEST MAIN ST. TILTON, N.H. 03276
603-286-4845 1-800-332-2621 www.tiltontrailer.com



METRO Walls



SNHU TUCKERMAN HALL
COMPLETED 2013

We have the manpower and the experience

Metro Walls delivers high-quality work, on-time and on budget as a full service commercial framing and drywall company serving New Hampshire, Massachusetts, Maine and Vermont.

"Metro Walls has worked with us on several large projects. We are always very pleased with the work provided. In addition to their excellent craftsmanship, they can manage aggressive deadlines without skipping a beat. They are true professionals in the industry and we enjoy working with them."

JOE CAMPBELL, VICE PRESIDENT - NORTH BRANCH CONSTRUCTION

VISIT US AT WWW.METROWALLS.NET

Providing drywall and metal framing solutions from our two locations

New Hampshire
49 Hancock Street
Manchester, NH 03101
(603) 668-2542

Maine
23 Evergreen Drive
Portland, Maine 04103
(207) 867-9065





Five Strategies to Deal With Opioid Dependence and Substance Abuse in Construction

BY DR. DEBORAH HAPP

According to estimates from CNA Insurance, illicit drug use among construction workers is at 15 percent—and construction industry employees are more likely to abuse opioids than employees in any other industry (except food service). The current opioid epidemic has been called the worst drug crisis in American history, reaching every corner of society, including workplaces across all industries. This epidemic involves the use of prescription opioid (pain) medications and illicit drugs including heroin and illegally manufactured fentanyl.

A survey recently released by the National Safety Council reveals more than 70 percent of workplaces are feeling the negative effects of opioid abuse. Nearly 40 percent of employers said employees are missing work due to abuse of painkillers, with roughly the same percent reporting employees abusing drugs on the job.

Workers in the construction industry are especially at risk for prescription opioid abuse. There are several factors that contribute to the high rate of opioid abuse in the construction industry. The field is male-dominated and males are twice as likely as females to abuse prescription medica-

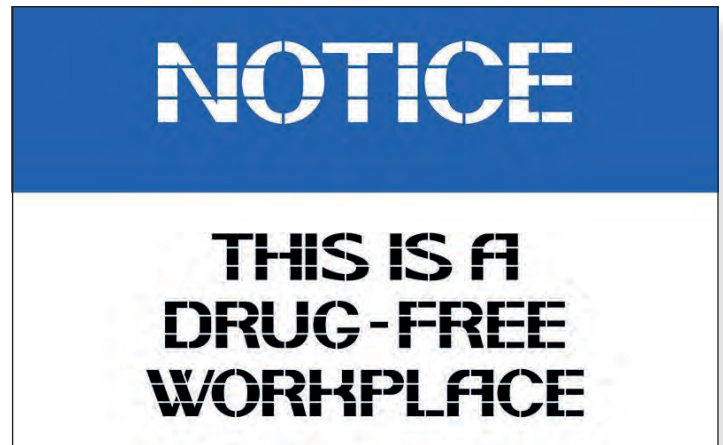

tions. Construction workers tend to face more physical wear on their bodies, increasing the likelihood for aches and pains. Finally, the risk of injury on the job is greater, which can lead to the prescription of opioids to treat the pain.

It's important to note that treating opioid dependence is costing companies huge dollars. The average cost to treat a non-opioid-abusing individual is \$3,435 compared to the average \$19,333 for an individual with opioid abuse or an opioid dependence diagnosis, according to The Impact of the Opioid Crisis on the Healthcare System, a FAIR Health Study.

The costs of opioid abuse in the workplace are not limited to healthcare claims costs. Other costs include lost time at work, job turnover and retraining. Despite the prevalence and costs of opioid and substance addiction in the construction industry, only a small percentage of those with opioid or other substance use disorders ask for or receive help.

Here are five ways construction businesses can take action with opioid dependence and substance addiction in their workplace.

1. EDUCATE EMPLOYEES

Educate employees about opioids, including how they work, how they interact with other drugs and alcohol, and how they can become addictive. It's also important to educate employees about alternative treatments for pain.

2. CREATE A NON-STIGMATIZING WORKPLACE

One way to influence more people to seek help is to convince them that getting treatment is the smartest thing to do. By talking about addiction like any other disease, leaders can silence the stigma and allow people to realize it's alright to ask for help. It's equally critical to send the message that the employee's workplace is a safe place, and the company is there to help.

Jeremy
HILTZ
EXCAVATING
INC.

Ashland, N.H.
968-9694



Spotlight your project!

NH Business Review is giving contractors the opportunity to spotlight a recently completed project in a special two-page center spread called "From the Ground Up." This special feature gives visibility to the construction industry while showcasing some of the most interesting projects here in New Hampshire.

Each feature includes photos and article about the project, and advertising from the architects, engineers, and subcontractors who have been directly involved with the project.

For more information call 603-413-5154 or visit nhbr.com



FROM THE GROUND UP: The Prologis project
Dacon Corporation, TFMoran, others team up to create 614,000-square-foot distribution center near Manchester airport

DAICON
Design / Build Services
Project Team: TFMoran (Architect) | CMIP Paving (Construction Oversight) | Construction Services | Talamo Engineers

CONTINENTAL PAVING, INC.
Landscaping • Turf • Sod
One Commercial Blvd
Londonderry, NH 03053
Tel: (603) 852-5154
Fax: (603) 852-5395
www.continentalpaving.com

MIS Services
Specialized Grading & Excavation Contractors
We are pleased to have obtained this exceptional project!

UPS Northeast Logistics Center
Londonderry, NH
In-house services TFM provided:
• Civil Site Grading & Planning
• Structural Engineering
• Traffic Engineering
• Stormwater Management
• Construction Inspection
• Land Servicing
• Landscape Architecture

Professional Services... Exceptional Results!
TFM **MISC**
Head Office: 100 Main St., Londonderry, NH 03053
Business, NH & Portsmouth, NH
(603) 413-2222
(603) 413-2222
www.tfmgroup.com

Granite State
Planning & Heating, LLC
Mechanical Contractors
• Commercial
• Industrial
• Multi-Phase
• Residential

Service
Ductwork
• Air Purification
• Heating
• Medical Gas
• Mechanical
• HVAC
• Hot Water
• Hydronic

PROJECT DETAILS
LOCATION: 52 PETERSHOLE ROAD, LONDONDERRY, NH
ISSUES: UPS, SES AND PRATT AND WHITNEY
DESIGNER: DAICON CORPORATION AND TFMORAN
CONSULTANTS: TFMORAN AND TFMORAN ENGINEERING
TIPOMOAN | TIPOMOAN.COM
BUILDING: CONTINENTAL PAVING - CONTINENTAL PAVING.COM

NH BUSINESS REVIEW
REAL ESTATE & CONSTRUCTION NEWS ROUNDUP MORE @ NHBR.COM

4 million U.S. homeowners are still underwater
While progress has been made, Zillow report finds stubborn problem remains

New Smuttynose facility wins regional energy-efficiency award
Hampton building cited for "outstanding innovation and commitment to sustainable energy practices"

Foundation placed for Bedford Whole Foods
40,000-square-foot store's shell expected to be completed by November

LGBT couples favor homeownership, fear discrimination
A powerful market with \$240 billion in buying power

7 deadly sins for design pros
Avoid legal complications by taking

NHBR newsletters
Subscribe to NHBR's News Browser and more
Your Email Address: _____

Stay connected with us
Jeff Fitzgerald
NHBR Editor
603-413-5118

No dream is too big. No idea is too small.
Service Credit Union has the mortgage you're looking for.
Lending Made Simple.
SERVICE CREDIT UNION

More industry news
Homestead Whelan Mills sold for \$10k at Seabreeze Auction | The Maine Sentinel
Price Rise plans to open its first Granite State grocery store... NH Union Leader

Sign up for NH Business Review's free Real Estate & Construction e-Newsletter

- Free weekly e-newsletter focusing on NH's real estate & construction industry
- Weekly roundup of stories from NHBR.com and statewide publications
- Emailed to more than 6,200 subscribers
- Advertising opportunities to reach a targeted audience

For all advertising opportunities, contact Kimberly Lencki at 603-413-5154



OPIOID, FROM PAGE 13

3. EQUIP STAFF TO RECOGNIZE THE SIGNS OF ADDICTION

It's important that management and staff be trained on the early signs of opioid and substance addiction—including irritability, poor concentration and declining performance—so they can intervene before the situation deteriorates. Train managers to address performance issues because that often opens up the dialogue to talk about sensitive matters. By showing genuine concern, managers gain the trust of employees, which allows them to guide their workers to the care they need.

4. OFFER SUPPORT TO EMPLOYEES AND FAMILY MEMBERS

Just as a manager would with an employee who has a medical condition, such as cancer or heart disease, managers need to offer non-judgmental support to employees with a substance abuse disorder. Remember, employees who have family members struggling with substance addiction suffer at work too. Those who are affected by a loved one's addiction can have increased absenteeism, lack of focus and health problems related to stress.

If a business doesn't already have one, consider providing an employee assistance program (EAP) for employees. EAP services can be an effective first step for employees and their dependents to initiate support

for nonmedical prescription drug problems. An EAP can offer counseling and referral services, conduct substance abuse evaluations or connect an employee to a qualified substance abuse professional. The best thing about an EAP is that it costs the employee nothing and is completely confidential.

5. HELP EMPLOYEES ACCESS TREATMENT

Ensure workers have access to quality treatment for substance addiction. Consult with the company's health plan provider about a comprehensive plan that covers inpatient and outpatient services. Employees with opioid addiction can often benefit from medication-assisted treatment, which reduces the cravings for opioids and allows employees to work while

in treatment.

By taking action and implementing these strategies, construction companies can create a safe work environment where employees feel supported and can do their best work. There's nothing more important than sending a message to workers that the company cares about their health and well-being.

Dr. Deborah Happ - Senior Vice President, New Directions Behavioral Health

New Directions provides employee assistance programs and managed behavioral health services to health plans and employers.

Reprinted from constructionexec.com, Feb. 20, 2018, a publication of Associated Builders and Contractors. Copyright 2018. All rights reserved.

SPECIALISTS IN:

- Computer Rooms
- Air Make-up Systems
- Industrial Humidification
- Steam and Hot Water Boiler Systems
- Plumbing
- Precision Temperature Control Systems
- Chilled Water Process Systems Engineering
- Energy Management Systems
- Maintenance Programs

www.jlawrencehall.com

17 Progress Ave., Nashua, NH 03062
Phone: (603) 882-2021 • Fax: (603) 882-1287



NO JOB TOO BIG



...because we can cover them all.



INSURANCE • BONDS • BENEFITS

...an Assurex Global Partner

1-800-238-3840

www.rowleyagency.com

Serving New England
Since 1966

Concord, NH
Portland, ME
Bennington, VT

Protecting your relationships.

In the design and construction industry, there is no better way to protect your relationships than by using AIA Contract Documents. As the Industry Standard for over 120 years, our pre-drafted agreements and forms define the relationships and terms involved in your project, ensuring all parties are aware of expectations. Developed with input from key stakeholders, and recognized by courts across the country, AIA Contract Documents protect your project from start to finish.

Learn More at www.aia.org/contractdocs
Paper documents are still available from AIANH, 606-357-2863, www.aianh.org

AIA Document C201™ – 2015
 Standard Form of Consultant's Services: Land Survey
 for the following PROJECT:
 (Name and location or address)

HL TURNER
advancing the technology, art, and science of the built environment

ARCHITECTURE **ENGINEERING** **BUILDING SCIENCE**

BUILDING DESIGN	STRUCTURAL	INDOOR AIR QUALITY
FEASIBILITY ASSESSMENT	CIVIL	BUILDING COMMISSIONING
CAPITAL IMPROVEMENT PLANS	DAMS & HYDRO	BUILDING SYSTEM
MASTER PLANNING	MECHANICAL / HVAC	PERFORMANCE/EVALUATION
ZERO NET ENERGY DESIGN		

27 LOCKE ROAD | CONCORD, NH | 603/228-1122 | HLTURNER.COM

DRUG- AND ALCOHOL-FREE WORKPLACE

Construction Coalition for a Drug- and Alcohol-Free Workplace

The Construction Coalition for a Drug- and Alcohol-Free Workplace (CCDAFW) was created with the purpose of providing companies and organizations with the resources necessary to successfully implement an effective substance abuse policy. Join your fellow industry leaders in pledging your support to work towards eliminating substance abuse-related incidents on construction jobsites!

Scan the QR code below or go to www.drugfreeconstruction.org for:

- Sample substance abuse policies
- Testing and substance guides
- State-by-state substance abuse testing guidelines
- Testing and regulatory resources
- The Drug- and Alcohol-Free Workplace Pledge!



NB North Branch Construction

Construction Manager • Design-Builder • General Contractor

2018 ABC NH/VT GOLD SPONSOR



2017 ABC NH/VT Award of Excellence
St. Paul's School
Ohrstrom Library Renovation

Concord, New Hampshire • (603) 224-3233 • www.northbranch.net





News of Our Members

■ **METRO WALLS, INC.** Manchester, NH was selected to provide commercial framing and drywall services for a new \$50 million assisted living center in Keene, NH. Metro Walls was proud to be chosen by fellow ABC member, The MacMillin Company, a DEW affiliate, for this project.



Hillside Village has received the go-ahead to begin construction for a 140-unit senior citizens complex on Wyman Road.

The complex is the result of a merger between Prospect Place and The Woodward Home, assisted living facilities on Court Street in Keene.

The complex will sit on 48 acres near the Black

Brook watershed and will feature a health care center, continuing care facility, 24 Woodside Apartments 'villas', and 114 independent living accommodations.

■ **METHUEN CONSTRUCTION** is thrilled to announce it's "Future Leaders Program Class of 2019." These teammates have been selected to participate in an 18 month program that will provide opportunities to build on their education and to advance both personally & corporately, enabling promising careers. The purpose of the

■ **RPF ENVIRONMENTAL, INC.**, Northwood, NH, an environmental health and safety (EH&S) consulting firm, is proud to announce that Adam Frey has joined the team and successfully completed his initial field training as an EH&S technician.

Mr. Frey earned a Bachelor of Science in environmental science from Southern New Hampshire University. Over the past year, he obtained three licenses for asbestos consulting and testing, training for OSHA compliance, experience with a wide array of air sampling methods, and certification for optical microscopy. He also gained hands-on training and experience in various projects involving many of the services provided by RPF Environmental.

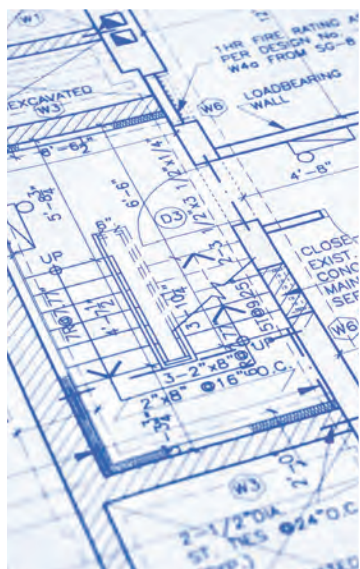

Contracts
Liens
Bond Claims
Mediation
Arbitration
Corporate
Litigation



Experienced Attorneys Serving the
Legal Needs of the Construction Industry

32 Daniel Webster Highway, Suite 14
Merrimack, New Hampshire 03054
PH: 603.595.4500 FX: 603.595.8500
www.gagliuso.com



Methuen Construction "Future Leaders Program Class of 2019". From left to right: Marcus Swedberg, Ben Raymond, Keith Maynard, Matt Gadziala, Denise Freudenberg, Michelle Douglass, Joann Pickard, Joe Barbone—President & CEO, & Bill Garland—Training and Development Specialist

Future Leaders Program (FLP) is to further develop a culture within the organization that will endure both external and internal challenges in an ever-changing world. To this end, the FLP aims to develop teammates to better influence others within Methuen Construction and enable them to share common goals, values and attitudes to work more effectively toward attaining our organization's short and long-term vision.

Also new to the team, RPF Environmental, Inc. announced that Drew Carter has joined the sales team as a Business Development Representative. Mr. Carter has an impressive track record in health industry sales, and



Drew Carter



THE INFORMATION SOURCE FOR OWNERS · ARCHITECTS · CONSTRUCTION PROFESSIONALS

GENERAL CONTRACTORS

Alpine Environmental, Inc.
Chelmsford, MA
www.alpine-environmental.com

Bancroft Contracting Corporation
South Paris, ME
www.bancroftcontracting.com

Bonnette, Page & Stone Corp.
Laconia, NH
www.bpsnh.com

Carrigg Commercial Builders LLC
Manchester, NH
www.carrigg.com

Charters Brothers Construction, LLC
Danville, NH
www.chartersbrothers.com

Cianbro Corporation
Pittsfield, ME
www.cianbro.com

CMGC Building Corp.
Manchester, NH
www.cmgcbuildingcorp.com

Cobb Hill Construction, Inc.
Concord, NH
www.cobhill.com

Construx, Inc.
Plymouth, NH
www.construxinc.com

Cutler Associates, Inc.
Worcester, MA
www.cutlerassociatesinc.com

D. L. King & Associates, Inc.
Nashua, NH
www.dlkingnh.com

Eckman Construction Co., Inc.
Bedford, NH
eckmanconstruction.com

Estes & Gallup, Inc.
Lyme, NH
www.estes-gallup.com

Fulcrum Associates, Inc.
Amherst, NH
www.fulcrum-nh.com

Green Mountain Pipeline Services, Inc.
Bethel, VT
www.greenmountainpipe.com

H.P. Cummings Construction Company
Woodsville, NH
www.hpcummings.com

JBR Associates, LLC
Amherst, NH
www.jbrnh.com

JCN Construction Co., Inc.
Dover, NH
www.jcnconstruction.com

LaMontagne Builders Inc.
Bedford, NH
www.lamontagnebuilders.com

Lewis Builders Development, Inc.
Atkinson, NH
www.lewisbuilders.com

Mark Carrier Construction, Inc.
Manchester, NH
www.mcci-nh.com

Meridian Construction Corporation
Gifford, NH
www.meridiannh.com

Methuen Construction Co., Inc.
Plaistow, NH
www.methuenconstruction.com

Morin Contracting Services, Inc.
Pembroke, NH
www.morincontractingservices.com

North Branch Construction
Concord, NH
www.northbranch.net

NorthPoint Construction Management, LLC
Hudson, NH
www.northpointcm.com

PROCON
Manchester, NH
www.proconinc.com

R.M. Piper, Inc.
Plymouth, NH
www.rmpiper.com

Schroeder Construction Management, Inc.
Nashua, NH
www.schroedercmi.com

SmartATI Construction
Rochester, NH
www.SmartATIconstruction.com

Structural Associates, Inc.
East Syracuse, NY
www.structuralassociates.com

Sullivan Construction, Inc.
Bedford, NH
www.sullivanconstruction.com

TCD Construction, Inc.
Peterborough, NH
tcdbuild.com

The MacMillin Co., LLC
Keene, NH
www.macmillin.com

Trumbull-Nelson Construction Co., Inc.
Hanover, NH
www.T-N.com

Turnstone Corporation
Milford, NH
www.turnstonecorp.com

W.M. Schultz Construction, Inc.
Ballston Spa, NY
www.wmschultz.com

SUBCONTRACTORS

A. J. Cameron's Sod Farms Inc.
Farmington, NH
www.cameronsoh.com

AA & D Masonry LLC
Manchester, NH

Accessibility Systems, Inc.
Claremont, NH
www.accessibilitysystems.com

Accurate Air, Inc.
Manchester, NH
www.accurateairinc.com

Al Terry Plumbing & Heating, Inc.
Hooksett, NH
www.alterryplumbing.com

All-Bright Systems, LLC
Salem, NH
www.all-brightsystems.com

Alliance Mechanical, Inc.
Essex Junction, VT
www.amivt.com

All-Ways Accessible, Inc.
Concord, NH
www.AWALifts.com

Alpine Environmental, Inc.
Chelmsford, MA
www.alpine-environmental.com

American Steel & Precast Erectors
Greenfield, NH
www.aspe-nh.com

Amherst Insulation & Firestop Service, Inc.
Manchester, NH

Andrews Construction Co., Inc.
Campton, NH
www.andrewsconst.com

ARC Mechanical Contractors
Bradford, VT
www.arcmech.com

Armand E. Lemire Co. Inc.
Hooksett, NH
http://armandlemire.wpengine.com/

Associated Concrete Coatings, Inc.
Manchester, NH
www.concoat.com

Bancroft Contracting Corporation
South Paris, ME
www.bancroftcontracting.com

Blaktop, Inc.
West Lebanon, NH
www.blaktop.com

Blue Ribbon Companies: Fence,
Landscaping, Recr.
Hooksett, NH
blueribbonnh.com

Bode Equipment Company
Londonderry, NH
www.bodeequipment.com

Bonnette, Page & Stone Corp.
Laconia, NH
www.bpsnh.com

Bouchard Steel Erectors LLC
North Bennington, VT

Bow Plumbing & Heating Corp.
Bow, NH
www.bowph.com

Caprioli Painting, Inc / CPI Floor Coatings
Newmarket, NH
www.capriolipainting.com

Chestnut & Cape, Inc.
Northwood, NH
chestnutandcape.com

Cianbro Corporation
Pittsfield, ME
www.cianbro.com

Cole Electric, Inc.
East Thetford, VT
www.coleelectric.com

Colonial Green Products Distributors, LLC
Rindge, NH
colonialgreenproducts.com

Construx, Inc.
Plymouth, NH
www.construxinc.com

Control Technologies
Manchester, NH
www.controltechinc.com

Covenant Fire Protection, Inc.
Manchester, NH
www.covenantfirepro.com

Damon Insulation Co., Inc.
Bow, NH
www.damoninsulation.com

Daniels Electric Corporation
Gifford, NH
danielselectriccorp.com

DECCO, Inc
Brookline, NH
www.decco.com

Denron Plumbing & HVAC, LLC
Manchester, NH
www.denronph.com

Dependable Controls Services LLC
Seabrook, NH
www.dependablecontrolsservices.com

Deventry Construction, LLC
Pembroke, NH
www.deventryconstruction.com

Door Control, Inc.
Londonderry, NH
www.doorcontrolne.com

Dowling Corporation
Portsmouth, NH
www.dowlingcorp.com

Eastern Vent Systems, Inc.
Pelham, NH
www.easternvent.com

Eckhardt & Johnson, Inc.
Manchester, NH
www.eckhardtjohnson.com

EMCOR Services New England Mechanical
Manchester, NH
www.nemsi.com

EnviroVantage, Inc.
Epping, NH
www.envirovantage.com

Ewing Electrical Co., Inc.
Deerfield, NH

Executive Building Systems, Inc.
Merrimack, NH
www.executivebuildingsystems.us

F.A. Gray, Inc.
Portsmouth, NH
fagray.com

F.H. Hamblet, LLC
Keene, NH
www.hambletelectric.com

Gate City Electric, LLC
Nashua, NH
www.gatecityelectric.com

George W. Pynn Masonry
Plaistow, NH
www.pynnasonry.com

Godin Associates, Inc
Lebanon, ME

Gorman-Thomas, Inc.
Bedford, NH
www.gormanthomas.com

Granite State Plumbing & Heating, LLC
Weare, NH
www.gsphinc.com

Hampshire Fire Protection Co. LLC
Londonderry, NH
www.hampshirefire.com

Harry-O Electrical Corporation
Loudon, NH
www.harryoelectrical.com

Interstate Electrical Services Corporation
Bedford, NH
www.iesc1.com

Irish Electric Corp.
Hopkinton, NH
www.irishelectric.net

J. Lawrence Hall Co., Inc.
Nashua, NH
www.jlawrencehall.com

Jamco Excavators, LLC
South Hampton, NH
www.jamcoexcavators.com

JDS Flooring Associates, LLC
Londonderry, NH
floornh.com

Jeremy Hiltz Excavating, Inc.
Ashland, NH
www.jeremyhiltzexcavatinginc.com

Johnson and Jordan, Inc.
Chichester, NH
www.johnsonandjordan.net

Keeley Painting Co., Inc.
Pittsfield, NH
www.keeleypainting.com

Laconia Refrigeration
Laconia, NH
www.laconiarefrigeration.com

Lawrence & Lober Electric, Inc.
Bellows Falls, VT
www.llelectricservices.com

Legacy Wall Systems
Hudson, NH
www.legacywall.net

Leighton A. White, Inc.
Milford, NH
www.leightonawhite.com

Longchamps Electric, Inc.
Manchester, NH
www.LongchampsElectric.com

Martineau Electric, Inc.
Dover, NH
www.martineauelectric.com

Mas-Con Corporation
Laconia, NH
www.mas-concorp.com

McEntee Masonry Contractors, Inc.
Lyndeborough, NH
mcenteemasonry.com

Merrimack Drywall, Inc./Merrimack
Estimators, Inc.
Dunbarton, NH
www.merrimackdrywall.com

Metro Walls, Inc.
Manchester, NH
www.metrowalls.net

MSI Mechanical Systems, Inc.
Salem, NH
www.msimechanical.com

Multi-Weld Services, Inc.
Contoocook, NH
www.multi-weld.com

New England Mechanical Overlay Inc.
Pittsfield, NH
nemoinc.net

Noonan Brothers Painting, LLC
Manchester, NH
www.noonanbrotherspainting.com

Norman E. Day, Inc.
Nashua, NH
www.normaneday.com

North & South Construction Services
Barrington, NH
www.northsouthnh.com

Northeast Safe-T Solutions, LLC
Londonderry, NH
www.safetyfloors.com

Oliver Mechanical, Inc.
Manchester, NH
www.olivermechanicalinc.com

Overhead Door Company
Portsmouth, NH
www.overheaddoorcompany.com

Palmer & Sicard, Inc.
Exeter, NH
www.palmerandsicard.com

Powers Generator Service LLC
Swanzey, NH
www.powersgenerator.com

Premier Concrete Construction LLC
Wilton, NH
www.premierconcretetell.com

Professional Waterproofing & Caulking
Nashua, NH
www.prowaterproof.net

Progressive Electrical Services, Inc.
Lee, NH
www.pesincnh.com

Raynor Door Authority of New England, Inc.
Manchester, NH
www.raynordoorauthority.com

Reliance Steel, Inc.
Colchester, VT
reliancesteelofvt.com

Richard Electric, Inc.
Wildor, VT
www.richardelectric.com

Riess Construction LLC
Plymouth, NH
www.riessconstruction.com

Rockingham Interiors
Salem, NH
www.rockinghaminteriors.com

Rose Steel Inc.
Greenland, NH
www.rosesteelinc.com

Royal Electric Co., Inc.
Woodsville, NH
www.royal-electric.biz

S.D.Szetela Masonry
Glen, NH
www.sdszetela.com

Sam Mechanical Services, LLC
Hooksett, NH
www.sammmechanical.com

Seacoast Scaffold & Equipment Corp.
Concord, NH
www.seacoastsccaffold.com

Secondwind Water Systems, Inc.
Manchester, NH
www.secondwindwater.com

Signarama of Concord
Concord, NH
www.signarama-concord.com

Simpson's Painting, Inc.
Derry, NH

S. L. Chasse Welding & Fabricating, Inc.
Hudson, NH
www.slchassesteeltefab.com

Solid Earth Technologies
Amherst, NH
www.solidearthtech.com

SSW Erectors, LLC
Morrisville, VT
www.sswerectors.com

St. Pierre, Inc.
Charlestown, NH
www.stpierreinc.com

Stanley Elevator Company, Inc.
Merrimack, NH
www.stanleyelevator.com

Superior Fire Protection, Inc.
Hooksett, NH
www.superiorfire.net

The RELCO Companies
South Easton, MA
www.gorelco.com

Tocco Bldg Systems - Electrical Contractors
Billerica, MA
www.toccocorp.com

V. R. Concrete, Inc.
Columbia, NH
www.vrconcrete.com

Viking Roofing
Hollis, NH
www.vikingroofingnh.com

W.M. Schultz Construction, Inc.
Ballston Spa, NY
www.wmschultz.com

White Diamond Painting, LLC
Barrington, NH
whitediamondpainting.com

Zampell Scaffolding, LLC
Newburyport, MA
www.zampell.com

SUPPLIERS

American Aerial Equipment LLC
No. Attleboro Falls, MA
www.americanaerialequipment.com

American Steel & Precast Erectors
Greenfield, NH
www.aspe-nh.com

B.K. Systems, Inc.
Pembroke, NH
www.bksystemsinc.com

Bode Equipment Company
Londonderry, NH
www.bodeequipment.com

Carroll Concrete Co. Inc.
Newport, NH
www.carrollconcrete.com

Casella Waste Services, Inc.
Salem, NH

Jd Charron, Inc.
Hooksett, NH
www.charroninc.com

Chasse Crane Services, LLC
Hudson, NH
www.slchassesteeltefab.com

Cohen Steel Supply Inc.
Concord, NH
www.cohensteel.com

Consolidated Electrical Distributors, Inc.
Manchester, NH
www.cedmanchester.com

Construx, Inc.
Plymouth, NH
www.construxinc.com

Control Technologies
Manchester, NH
www.controltechinc.com

Door Control, Inc.
Londonderry, NH
www.doorcontrolne.com

Eastern Propane & Oil
Rochester, NH
www.eastern.com

Everett J. Prescott, Inc.
Gardiner, ME
www.ejprescott.com

F. A. Gray, Inc.
Portsmouth, NH
fagray.com

Hampshire Fire Protection Co. LLC
Londonderry, NH
www.hampshirefire.com

HD Supply - White Cap Construction & Industrial
Manchester, NH
www.whitecap.com

Independent Electric Supply
Manchester, NH
www.iesbuy.com

Jeremy Hiltz Excavating, Inc.
Ashland, NH
www.jeremyhiltzexcavatinginc.com

LaValley Building Supply, Inc.
Newport, NH
www.lavalleys.com

Merrimack Building Supply, Inc.
Merrimack, NH
www.merrimackbuildingsupply.com

New England Scaffolding, Inc.
Bow, NH
www.nesccaffold.com

NorthEast Electrical Distributors
Brockton, MA
www.needco.com

Northern Design Precast, Inc.
Loudon, NH
www.ndprecast.com

Novel Iron Works, Inc.
Greenland, NH
www.noveliron.com

Page Street Leasing, LLC
Candia, NH
www.pagest.com

Powers Generator Service LLC
Swansey, NH
www.powersgenerator.com

ProQuip Rentals & Sales, Inc.
Gorham, NH
www.proquipnh.com

RediMix Companies, Inc.
Manchester, NH
www.redimixcompanies.com

Riess Construction LLC
Plymouth, NH
www.riessconstruction.com

Russell Supply Corp.
South Burlington, VT
www.russellsupply.com

Seacoast Scaffold & Equipment Corp.
Concord, NH
www.seacoastsccaffold.com

Signarama of Concord
Concord, NH
www.signarama-concord.com

S. L. Chasse Welding & Fabricating, Inc.
Hudson, NH
www.slchassesteeltefab.com

St. Pierre, Inc.
Charlestown, NH
www.stpierreinc.com

Superior Sheet Metal
Hudson, NH
www.superiorsm.com

The Granite Group
Concord, NH
www.thegranitgroup.com

Tilton Trailer Rental Corp.
Tilton, NH
www.tiltontrailer.com

United Rentals, Inc.
Hooksett, NH
www.unitedrentals.com

W. D. Matthews Machinery
Concord, NH
www.wdmatthews.com

Wallboard Supply, Inc.
Londonderry, NH
www.wallboardsupplyco.com

Williams Scotsman, Inc. (13610)
Pelham, NH
www.willscot.com

Zampell Scaffolding, LLC
Newburyport, MA
www.zampell.com

ASSOCIATES

ABC Self Insured Group Trust For WC / FutureComp
Bedford, NH
www.usi.biz

Albin, Randall & Bennett, CPAs
Portland, ME
www.arbcpa.comBank of New Hampshire

Laconia, NH
www.laconiasavings.com

Bruce Ronayne Hamilton Architects Inc.
New Ipswich, NH
www.brharch.com

CGI Business Solutions
Hooksett, NH
cgibusinesssolutions.com

ConEst Software Systems
Manchester, NH
www.conest.com

Contractors Risk Management, Inc.
Concord, NH
www.crmusa.com

ConvenientMD Urgent Care
Portsmouth, NH
www.convenientmd.com

Cross Insurance Agency
Manchester, NH
www.crossagency.com

Cultural Chemistry, LLC
Deerfield, NH
www.culturalchemistry.com

Devine, Millimet & Branch PA
Manchester, NH
www.devinemillimet.com

Enterprise Fleet Management
Burlington, MA
www.enterprise.com/fleets

ExpressMED
Manchester, NH
expressmed.nh.com

Gagliuso & Gagliuso, PA
Merrimack, NH
www.gagliuso.com

GranitPath
Milford, NH
www.granitpath.com

GZA GeoEnvironmental, Inc.
Bedford, NH
www.gza.com

Hinckley Allen
Manchester, NH
www.haslaw.com

J. P. Pest Services
Milford, NH
www.jppestservices.com

Melanson Heath
Manchester, NH
melansonheath.com

Nathan Wechsler & Co., CPA
Concord, NH
www.nathanwechsler.com

PeopleReady
Bow, NH
www.clp.com

Preti Flaherty LLC
Concord, NH
www.preti.com

Quirk Chevrolet, Buick, Hummer
Manchester, NH
www.quirkcommercial.com

Resource Options, Inc.
Londonderry, NH
www.resourceoptions.com

RPF Environmental, Inc.
Northwood, NH
www.airpf.com

Saymore Trophy Company
Concord, NH
www.saymoretrophy.com

Service Credit Union
Portsmouth, NH
www.servicecu.org

Signarama of Concord
Concord, NH
www.signarama-concord.com

Stoneman, Chandler & Miller
Boston, MA
www.scmllp.com

Strang, Scott, Giroux & Young, LLP
New London, NH
www.strangscott.com

Team Engineering
Bedford, NH
www.engineerNH.com

Terracon
Manchester, NH
www.terracon.com

TFMoran, Inc.
Bedford, NH
www.tfmoran.com

The H. L. Turner Group, Inc.
Concord, NH
www.hlturner.com

The Lawson Group
Concord, NH
www.slgil.com

The Rowley Agency, Inc.
Concord, NH
www.rowleyagency.com

Tradesmen International
Bedford, NH
www.tradesmeninternational.com

TradeSource
Hooksett, NH
www.tradesource.com

Travelers
South Portland, ME
www.travelers.com

USI - New England
Bedford, NH
www.usi.biz

Warrenstreet Architects, Inc.
Concord, NH
www.warrenstreetarchitects.com

Works In Progress
South Burlington, VT
www.worksinprog.com



ABC's Upcoming Events

**March
2** **ABC Ski Day**
Waterville Valley Ski Resort
Waterville Valley, NH

**April
19** **Northern Region Celebrate Spring Mixer**
Woodstock Inn & Brewery
Woodstock, NH

**May
11** **Swing Into Spring Golf Tournament**
Breakfast Hill Golf Club
Greenland, NH

**June
28** **Merit Shop Night at the Ballpark**
Safety Awards Presentation & Graduates Recognition
Fishercats Northeast Delta Dental Stadium
Manchester, NH

**July
19** **FLiC Vermont Graduation & Mixer**
Blackback Pub
Waterbury, VT

**August
9** **Seacoast Harbor Cruise**
Isles of Shoals Steamship Co.
Portsmouth, NH

**October
25** **Excellence in Construction Awards**
Manchester Country Club
Manchester, NH

**December
6** **Annual Holiday Party**
TBD

Visit abcnhvt.org for more information





MEMBER NEWS, FROM PAGE 19

a well-developed aptitude for complicated, technical products. He will be a great benefit to RPF Environmental, Inc. and its customers.

Mr. Carter earned a Bachelor of Science in international business with a minor in marketing from Franklin Pierce College. Prior to joining RPF Environmental, he was an account manager at OSRAM Sylvania and OSRAM Opto Semiconductors, a pharmaceutical sales representative at Shionogi & Co., Ltd., and an outside sales representative at Lincare—a supplier of respiratory care. Most recently, he was a sales director at Biz to Biz Network Inc. Mr. Carter is quickly coming up to speed to provide exemplary service to RPF Environmental's customers.

NORTH BRANCH CONSTRUCTION of Concord has recently completed construction of a new satellite retail facility for CarMax Auto Superstores on Keller Street in Manchester, expanding the nationwide used car retailer's Boston market area with its 1st store in New Hampshire. The 9.66 acre site was previously

developed as a Walmart, which was demolished to make way for the new 17,758-square-foot sales and service building featuring a showroom and



CarMax Auto Superstores

community Building. Renovations will include improvements to kitchens and bathrooms, replacement of mansard roofs and trim, windows, replacement of five 10,000-gallon oil-fired furnaces with gas-fired furnaces, refurbishment of elevators, the addition of a new asphalt driveway to increase visitor parking spaces, life safety improvements, and the reconfiguration of the Community Building to repurpose its interior space to provide office space for Management & Leasing as well as additional resident recreational uses. All apartments will remain occupied throughout construction, requiring the highest level of coordination by North Branch Construction.

Burnell Johnson Architects of Manchester, NH are providing architectural design for the project, which is expected to be complete by the end of the year. The project is funded through Low Income Housing Tax Credits (LIHTC) administered through the New Hampshire Housing Finance Authority (NHHFA).

PROCON of Manchester, NH returned to Merrimack College as their as the Architect and Construction Manager for the 16,000 SF two-story Dr. Alfred L. Arcidi Welcome Center.

The facility will house the undergraduate and graduate admissions, the O'Brien Center for Career Development, and also provide specialty meeting spaces serving the entire campus. The Dr. Alfred L. Arcidi Welcome Center will border the recently opened Crowe Hall, and will support the college's goal of transforming the North District into the focal point of campus.

presentation lanes. The facility also includes a 936-square-foot car wash building, a 402-space sales lot, a 203-space customer parking lot, and a 2.74 acre vehicle staging area. North Branch Construction completed the project on time with an aggressive schedule of just eight months. Pieper O'Brien Herr Architects of Alpharette, GA provided design services for this project.

North Branch Construction of Concord has recently begun the \$11.5 million renovation of Cimmarron Apartments located just off Interstate 95 on Batchelder Road in Seabrook, NH. Owned by Chartwell Holdings, Cimmarron Apartments offer quality, affordable housing to New Hampshire's Seacoast and the North Shore of Massachusetts.

North Branch Construction will renovate six, four-story residential buildings totaling 388 units, as well as a stand-alone, 2,400-square-foot Com-



CONSTRUCTION

PeopleReady Speaks Construction

A partnership with PeopleReady allows you to get the skilled tradespeople you need, precisely when and where you need them. With our national team of local experts and decades of experience, we can create a custom workforce solution that fits your individual needs.

PeopleReady.com



MEMBER NEWS, TO PAGE 27



Think of us as your own personal Swiss accounting knife.

Nathan Wechsler & Company.
Because only the financially prepared survive.



Nathan Wechsler
Accountants & Business Advisors

70 Commercial Street, 4th Floor, Concord, NH 03301 603.224.5357

44 School Street, Lebanon, NH 03766 603.448.2650

www.nathanwechsler.com



RAYNOR
door authority
of New England

Contact us today!
1-888-229-3667

- Residential Garage Doors
- Commercial Garage Doors
- Specialty Products



Serving:
New Hampshire
Northeastern MA
Southern ME

www.raynordoorauthority.com

444 East Industrial Park Dr. Unit # 1 | Manchester, NH 03109

Longchamps
Electric Inc.

ELECTRICAL CONTRACTORS

"For large or small projects,
our quality and expertise are unmatched."

- Experts at Design-Build
- Fire Alarm Installations
- Fast Track Projects
- Emergency Generators
- Control Wiring
- Computer Aided Design (CAD)



700 Harvey Road
Manchester, NH 03103
P: (603) 625-5954

www.LongchampsElectric.com

We've been in business since 1978
and a lot of people know who we are
but very few people know what we do.
We are about to change that!!

HEALTH & SAFETY / WORKERS' COMP / WELLNESS



The Lawson Group is committed to preventing injuries on the job, lowering workers' comp costs and improving the health and wellness of your workforce.



Scott

For more information,
contact us at 800.645.7674
or visit thelawsongroup.com



Door Control, Inc.

Automatic Pedestrian Doors

Design Assistance • Installation • Service

Where Quality is Automatic

Pedestrian Automatic Door Systems

Sliding, Swinging, Bifolding, Revolving, Handicap
Accessibility Door Operators, All Glass Automatic
Door Systems, Automatic Sliding Fire Doors

Automatic/Manual Window Systems

High Security Drive-Up/Walk-Up
Fast Food Drive-Up
Pharmacy Drive-Up

Specialty Door Systems

Manual & Security Revolving Doors
ICU/CCU Sliding Door Systems
Industrial Door Systems
Clean Room Door Systems
Stainless Steel/Muntz Clad Doors
Explosion Proof Door Systems
Fire Rated Slide Doors

Maintenance Services

24x7 Service Response
Call Service & Planned Maintenance
Parts & Service -- All Manufacturers

Other Services

Motion Detectors & Photo Electrics
Control Switches & Floor Mats
Manual Door Closers & Exit Devices
Electric Locking Devices
Card Access Systems

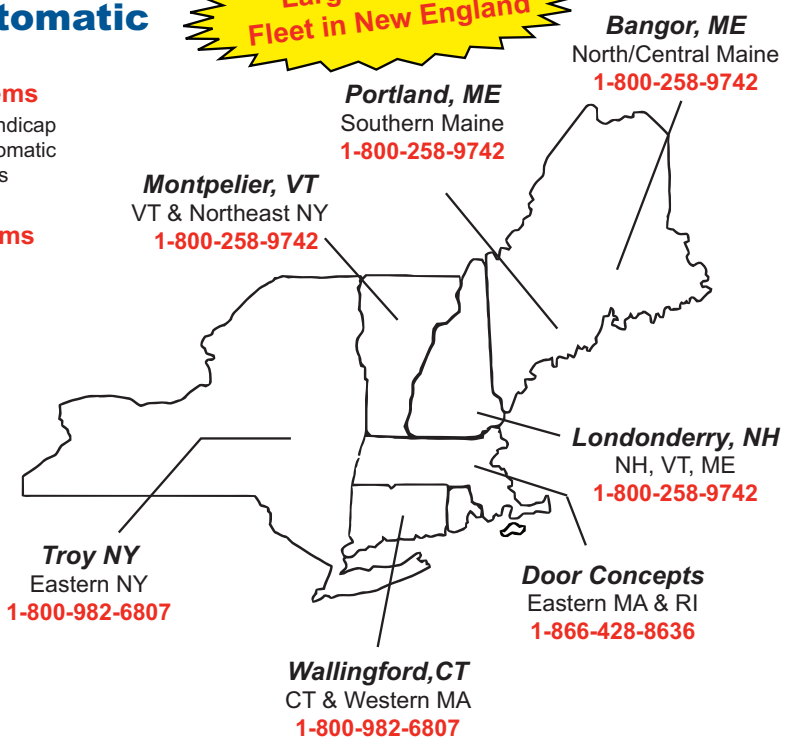

Specializing in:

- Hospital Entrances
- Handicap Doors
- Supermarkets
- Office Buildings
- Industrial Doors
- Shopping Malls



Full Compliance with
The Americans with
Disabilities Act



American Association of
Automatic Door Manufacturers



Certified Technicians

www.doorcontrolne.com

sales@doorcontrolne.com Tel: 1-800-258-9742 Fax: 1-800-594-8352



MEMBER NEWS, FROM PAGE 23

The center's key features will include nine interview/advising rooms, administrative offices,



a student interview preparation space, a boardroom and five conference rooms. Large groups will be able to assemble in a 1,100 SF presentation room to learn about the college. The first floor lobby area was designed featuring floor-to-ceiling windows for a sophisticated first impression.

The Welcome Center is expected to open in fall 2018.

PROCON of Manchester, NH is the designer and builder of the 45,000 SF addition and the company's Vice Chairman John

Samenfeld was on hand for the occasion.

It was a brisk winter morning as attendees arrived and signed their names on the 168-pound beam. Rand-Whitney President Nick Smith opened up the event and talked about what the building upgrades will mean for their company's headquarters. "This expansion will allow us to become even more efficient than we already are. We want the end-result to be a first-class campus for our flagship facility, and also be one of the most efficiently run plants in New England."

City Councilor George Russell took a few moments to talk about the project's impact on the city of Worcester. He said, "Nothing is better than seeing people getting jobs and working in this city." Rand-Whitney was great in their communication with us. They took the time to explain a good plan to the city that would have a minimal impact on the neighborhood. And, I hope that we will continue to see more of this."

The expanded area will be used for much needed additional storage space, as well as for a state-of-the-art waste extraction system and 22 dock doors. The site refurbishments will also

include a shipping/receiving area, increased trailer storage, a driver's office area and modifications to the existing parking area. When complete, the existing building and expansion will total 201,400 SF.

■ **TFMORAN, INC.** announces the recent addition of Engineering Technician, Andrew Gray, EIT to their Portsmouth division team. Mr. Gray graduated from the University of Alaska Anchorage with a Bachelor of Science degree in Civil Engineering. In addition to septic system design, his over ten years of experience includes civil project management, permitting, construction inspection and oversight, and geotechnical investigations.



Andrew Gray

Prior to TFMoran, Mr. Gray was the SWPPP lead inspector for the \$14M Portage Cove Harbor Expansion in Haines Borough, Alaska.

Eric Picard, PE, also of TFMoran, recently passed the Professional Engineer exam and is now a licensed structural

MEMBER NEWS, TO PAGE 29

New Member Spotlight



Northeast Flooring – Dan Livingston

Londonderry, NH 03053 • (603) 434-7009 • www.safetyfloors.com

Northeast Safe-T Solutions is a one stop shop for all flooring needs. We have the experience to make any project a success. We have a proven track record and have satisfied customers to back us up.



ABC NH/VT Annual Meeting & Board Induction



Were You Seen at
the ABC
New Hampshire/
Vermont 2018
Annual Meeting?

.....





MEMBER NEWS, FROM PAGE 27

engineer in New Hampshire. Mr. Picard joined the TFMoran Structural Team in 2013 after obtaining a Bachelor of Science in Civil Engineering degree from the University of New Hampshire, Durham. His experience includes the design, analysis and construction administration of municipal, commercial,



Eric Picard

industrial and residential projects throughout New England. Mr. Picard is a member of the Structural Engineers of New Hampshire.

Dylan Cruess, TFMoran's chief operating officer and principal, has been named to the 40 Under Forty Class of 2018. The New Hampshire Union Leader's "40 Under Forty" acknowledges New Hampshire residents under the age of 40 for professional and personal contributions that make New Hampshire a better place to live and work. Cruess, 38, lives

in Bedford and has been involved in his family's engineering business in various capacities since he was 10.

He, along with the other TFMoran principals, encourage their entire team to become involved in the communities in which they live through support of non-profit, industry, and community organizations. Mr. Cruess credits the amazing people he works



Dylan Cruess

with who help shape communities through new development every day. His engineering firm has a keen focus on STEM (Science, Technology, Engineering, Mathematics) initiatives and supporting personal causes of employees and clients. Mr. Cruess volunteers on the Board of Directors for the Greater Manchester Chamber of Commerce, and as treasurer for the Manchester Masonic Foundation.



Send us your company's latest news!



Application Now Online!



Associated Builders
and Contractors, Inc.

abc.org/aqc

BE BUILD
THE WITH THE
BEST

When you choose to work with an **ACCREDITED QUALITY CONTRACTOR** (AQC), you choose to work with the best of Associated Builders and Contractors' more than 21,000 member firms.

The AQC designation provides national recognition to construction firms that document their commitment to quality achievement in five areas of corporate responsibility: quality, safety training, community relations and diversity, employee benefits and employee training.



Are You Interested in Being 770 Percent Safer Than the Industry Average?

And sending your employees home safe to their families every day?

It's more than possible. It's doable! ABC's Safety Training Evaluation Process (STEP) provides members with a safety benchmarking and improvement tool with proven results. The best-performing companies dramatically reduced recordable incidents compared to the industry average. Read more in the ABC 2017 Safety Performance Report at abc.org/SPR.

Applying world-class processes dramatically improves safety performance among participants regardless of company size or type of work. Learn the 20 Key Components of effective safety and training programs and measure your performance through the online STEP questionnaire.

STEP companies know safety success isn't measured by numbers alone. Be recognized for your safety excellence or get started for free today at abc.org/STEP.

Apply by May 14, 2018 to be eligible for recognition at the NH/VT Annual Employee Appreciation and Safety Awards event!



New Hampshire/
Vermont Chapter



When it comes to looking out for your best interests, you can count on Cross for prompt, professional service.

By selecting policies from only the top carriers, our experienced insurance professionals can find the right coverage for you.



Infantine Insurance
A Division of Cross Insurance



Infantine Insurance:	203 Meetinghouse Rd. Bedford	603-669-0704
Cross Insurance:	155 Court St. Laconia	603-524-2425
	110 Elm St. Manchester	603-669-3218

Contact us for all your Insurance and Surety Bonding Needs!

CROSSAGENCY.COM

Official Insurance Broker:





ABC YOUNG PROFESSIONALS GROUP

An affiliate of Associated Builders and Contractors
New Hampshire/Vermont Chapter



Founded in 2012 as an initiative of ABC NH/VT, the mission of the ABC YPG is *to develop, empower, and connect young professionals through events in an effort to enhance their professional development and business success within the construction industry.*

All of our events, seminars, and collaborations are open and available to everyone - from those just starting their careers to seasoned professionals. We strive to connect individuals of all ages and backgrounds across the construction industry. By coming together to network and unite, we make our partnerships stronger and more fulfilling.

Creating Future Company Leaders

2018 SPONSORSHIP OPPORTUNITIES

Platinum Sponsorship (\$1,200.00) Includes logo on all marketing & event communication throughout the year, logo on website with link to company site, name recognition at all events, logo on all event posters & flyers, and 4 free tickets to all YPG-hosted events (excluding the annual charity event)

Gold Sponsorship (\$1,000.00) Includes logo on all marketing & event communication throughout the year, logo on website with link to company site, name recognition at all events, logo on all event posters & flyers, and 2 free tickets to all YPG-hosted events (excluding the annual charity event)

Bronze Sponsorship (\$750.00) Includes written name on all marketing & event communication throughout the year, written name on website with link to company site, and written name on all event posters & flyers

WHY SPONSOR?

Corporate sponsorship monies help the ABC YPG remain a no dues organization. This encourages all young professionals to participate, regardless of their financial situation. As the membership grows, and the need for a greater diversity of professional development and networking arises, sponsorship monies will ensure that our members continue to receive quality opportunities for growth as young professionals.

Contact info@abcypg.org to learn more about becoming a sponsor.

www.abcypg.org



facebook.com/abcypg
twitter @abcypg
instagram @abcypg



2018 UPCOMING EVENTS

**mar
15** **Irish Pub Party**
Shaskeen Pub
Manchester, NH

Brewery Tour
Join us for networking & a tour
Location TBD

**spring
TBD**

**may
11** **ABC Golf Tournament**
Join us at the air cannon!
Breakfast Hill Golf Club

ABC Harbor Cruise
Seacoast Region Networking
Portsmouth, NH

**aug
9**

**sep
13** **Annual YPG Social**
Manchester Country Club
Bedford, NH

Charity Bowling Tournament **nov
8**
Merrimack Ten Pin Center
Merrimack, NH

interested in sponsoring an event?
our event sponsors' logos are displayed on all event signage, flyers, and email marketing
for pricing contact: info@abcpypg.org

THANK YOU TO OUR 2018 PLATINUM SPONSORS



SIGNARAMA

WHERE THE WORLD GOES FOR SIGNS

DIMENSIONAL LETTERS / LOGOS

Using stock materials such as Acrylic, PVC and HDU we can produce dimensional letters and logos that will give your business a professional look. We can add letters to a flat sign for a "3D" appearance or LED lights to the back for a "halo" effect.



CHANNEL LETTERS

We are a premier manufacturer of interior and exterior channel letters. Our streamlined and lean manufacturing processes allow us to produce projects of any size. From technical drawings to installation of 1 set or 500, we are the right source.



CARVED SIGNS/BLANKS

Our CNC Router allows us to manufacture visually effective signs that will work hard and bring in more clients. We can supply with a painted finish or as blanks wholesale to the sign industry.



SIGN CABINETS

We design and manufacture our cabinets with quality materials for applications ranging from monument style to roof mount. We offer custom shapes as well.



CNC SERVICES

Our CNC 3 Axis Router allows us to service many industries outside the sign industry. If you have a need for competitive, high quality routed piece parts in Acrylic, PVC, Wood or Lighter Gauge Aluminum, we are the place to go.



SERVICE/INSTALL

Our dedicated service and installation team is on the road and in the air everyday. We can ensure your lit and non lit signs look good and perform properly. Our service contracts reduce costs on parts and labor.



LARGE FORMAT PRINTING

Vinyl Applications:

- Indoor Banners
- Outdoor Banners
- Window Displays
- Poster and Photo Prints

- Lightbox Signs
- Custom Wall Murals
- Metal Signs
- Yard Signs

- Trade Show Displays
- Vehicle Graphics
- Vehicle Magnets
- Foam Boards



603-225-4081 • signs@signarama-concord.com



Granite State Plumbing & Heating, LLC

A division of **COMFORT SYSTEMS USA**
Quality People. Building Solutions.

Toll Free (866) 540-1542
Phone (603) 529-3322
Service (603) 529-3331

www.gsphinc.com

Mechanical Contractors

- Commercial
- Industrial
- Institutional
- Multi-Family
- Design/Build



Service Department

- Refrigeration
- Heating/AC
- Medical Gas
- Plumbing
- 24-Hour Service
- PM Contracts

Recent & Current Projects

NovoNordisk • Lebanon, NH
Great Glen Hotel • Greens Grant, NH
FW Webb Distribution Center • Londonderry, NH
Plymouth State University Residence Hall • Plymouth, NH
Bluebird Self Storage • Manchester, Hooksett, Bedford, NH
Southern NH University Athletic Complex • Manchester, NH

**NEW SERVICE LOCATION: 10 TECHNOLOGY DRIVE
UNIT 1A
WEST LEBANON, NH 03784**

Proudly Serving the New Hampshire Construction Community Since 1983

We have the products to make all your projects comfortable year-round.



Colonial Green Products strives to bring a higher standard of comfort to New England homes and businesses.



- Spray foam insulation
- Cellulose insulation
- Fiberglass insulation
- Spray foam roof systems
- All Division 7 components



603-532-7005

www.ColonialGreenProducts.com

- 1032 Route 119, Unit 6
Rindge, NH 03461
- 1725 Main Street, #5
Sanford, ME 04073

SERVING NEW HAMPSHIRE • MAINE • VERMONT • MASSACHUSETTS



Delivering safe, innovative approaches to managing high-risk, technically complex projects

The EnviroVantage role is to perform the initial environmental cleanup with attention to the overall considerations of the project. Having successfully completed thousands of projects, we believe in a “team” philosophy. EV understands that by partnering with owners, general contractors, and consultants it ensures our customers receive the most efficient, cost effective, and safest projects possible.



EnviroVantage[®]
ASBESTOS ABATEMENT. REMEDIATION. DEMOLITION. [.com](http://www.EnviroVantage.com)

800-640-5323
www.EnviroVantage.com

+ MOVE IN. START WORKING. FOCUS ON YOUR GOALS.

When the building is just right, productivity is all you see. When you order space solutions from Williams Scotsman, you get much more than just the space. You get the building configuration, the furniture, the fixings and even the coffee maker. This total solution approach delivers an ease of doing business none of our competitors can match. We do what we do best, so you can concentrate on doing what you do best - working your project, being productive, meeting your goals.

Contact your local sales representative at 800-782-1500 or visit us at willscot.com



DUCTWORK

PIPING

HVAC

PLUMBING

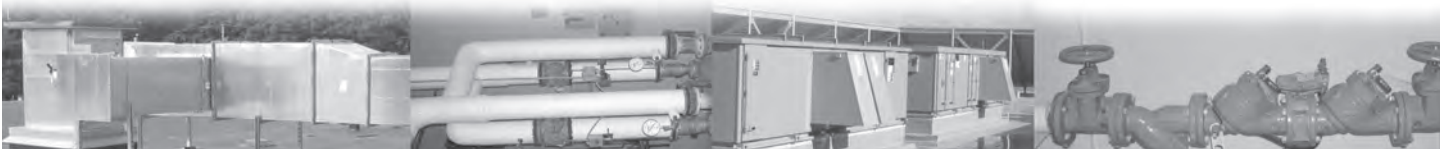

Thinking prevention.
Delivering reliability.
Being cost-effective.

Since 1917.

Eckhardt & Johnson, Inc.
MECHANICAL CONTRACTORS



896 Goffs Falls Road, Manchester, NH
603-622-7493
www.eckhardtjohnson.com

SERVICE

- Plumbing
- HVAC
- Service Agreements
- Maintenance Contracts

NEW CONSTRUCTION

- Hospitals
- Schools
- Office Buildings
- Manufacturing & Industrial Facilities
- Housing Projects
- Hotels
- Correctional Institutions

RENOVATION

- Boiler Replacement & Repairs
- Cooling Towers & Chillers
- Air Conditioning & Heating Equipment
- Process Piping
- Tenant Fit Up
- Turnkey Mechanical Systems
- Certified Medical Gas Installers
- Make Up Air Units

DESIGN/BUILD

- Plumbing
- HVAC
- Sheet Metal
- Process Piping



Become an ABC Member for Free!

When you join Associated Builders and Contractors (ABC), you become part of the nation's leading association for merit shop construction and construction-related firms.

Your Discounts Offset the Membership Fee

Every business is different, but every contractor has expenses. Here's how much a typical contractor with 15 employees can expect to save in one year with just a few of the ABC member business discounts.

Example of Company Savings

Product or Service		Savings
Chevrolet Cargo Van	1 vehicle	\$1,000
FedEx Shipping	2 envelopes/week	\$628
Verizon Wireless Service	7 cell phones	\$980
Aramark Apparel Rental	8 rentals/week	\$850

Total Savings for Year: \$3,458

“Our construction business has 18 employees. Currently, we're saving \$4,176 with two of ABC's discount programs, which more than pays for our membership dues.”

—Pamela Volm
Annapolis Contracting, Inc.

Saving You Money*

Tap into exclusive discounts for ABC members and save on business services and products you're already purchasing.

- **Enterprise** – Save up to 15% on vehicle expenses. GM and Ford discounts apply.
- **General Motors** – Save up to \$1,000 per vehicle on top of other incentives
- **Verizon Wireless** – Save up to 22% on mobile phone plans
- **FedEx** – Save 29% on overnight delivery services
- **Ford** – Save up to \$3,000 per fleet vehicle on top of other fleet discounts
- **Aramark** – Save 20% on safety apparel
- **And More!** – See all the programs at www.abc.org/discounts.

* Vendors and discounts subject to change.

Building Your Business

Take advantage of great resources and programs to grow your business.

- **Accredited Quality Contractor** – Shows prospective clients that you have achieved a high level of corporate responsibility
- **Safety Training Evaluation Process** – Improves your company's safety practices and can lower your workers' compensation insurance rates
- **Excellence in Construction Awards** – Showcases your company's best projects
- **Networking Events** – Connects you with contractors and leaders in the construction field
- **Peer Groups** – Share experiences with contractors from across the country

Keeping You Informed

ABC provides resources to help you stay current with the information you need to make better business decisions.

- **Construction Executive** – The magazine for the business of construction
- **ABC Newslines** – Weekly electronic newsletter for merit shop contractors
- **Local Newsletters** – Print and electronic publications of regional interest
- **Legal Resources** – Get help on labor and construction law issues
- **Construction Economic Update** – Stay current on news that impacts your business

Learn More Today! Find the ABC chapter in your area.

Online: www.abc.org/join — Email: members@abc.org



No dream is **too big.** No idea is **too small.**

Service Credit Union is the perfect fit for your business.

We offer long-term, fixed-rate commercial real estate and construction loan options. By getting to know your business we can provide a package of services just right for your needs.

We offer the peace of mind of working with an organization built on a long history of responsibility, honor and member focus.

**Speak with a dedicated
Business Services Representative
today at 603.422.8439.**

SERVICE[®]
CREDIT UNION
★★★★★



Customer Satisfaction

Quality Installations

Reliability

MARTINEAU ELECTRIC INC.

Serving New Hampshire, Maine & Massachusetts

603.742.0677

martineauelectric.com

INDUSTRIAL • OFFICE • HOTEL • COMMERCIAL

Advertiser Index

ABC-Accredited Quality Contractor (AQC)	29	Jeremy Hiltz Excavating, Inc.....	13
ABC-Become a Member.....	38	J. Lawrence Hall Co., Inc.....	15
ABC-Career Path.....	back cover	Longchamps Electric.....	25
ABC-Chapter Ads	22	Martineau Electric, Inc.	40
ABC-Discounts	inside back cover	Meridian Construction Corp.	8
ABC Group Trust / USI	4	Metro Walls, Inc.	12
ABC Premier Sponsors.....	10	Multi-Weld Services Inc.	9
ABC-Safety Training Evaluation Process	30	Nathan Wechsler & Co.....	24
AIA-NH	17	NH Business Review	14
Colonial Green Products Distributors, LLC.....	35	North Branch Construction, Inc.....	18
Construction Coalition for a Drug- and Alcohol-Free Workplace (CCDAFW)	17	Page Street Leasing, LLC.....	7
Construx, Inc.....	3	People Ready	23
Cross Insurance/Infantine Insurance	31	Raynor Door Authority of New England	25
Devine, Millimet & Branch PA	2	RPF Environmental.....	6
Door Control, Inc.....	26	Service Credit Union.....	39
Eckhardt & Johnson.....	37	Sign A Rama of Concord.....	34
Envirovantage	36	S.L. Chasse Steel.....	5
Gagliuso & Gagliuso, PA	19	The H.L. Turner Group.....	17
Granite State Plumbing & Heating, LLC.....	35	The Lawson Group.....	25
Hampshire Fire Protection Co., Inc.	inside front cover	The Rowley Agency.....	16
		Tilton Trailer Rental.....	11
		USI - New England.....	11
		Williams Scotsman.....	37

Upcoming Events

Northern Region Celebrate Spring

Join us in the heart of the White Mountains for some beers with your peers ... and let's celebrate Spring!

Thursday, April 19, 2018, 5-8:00 PM

Woodstock Inn, Station and Brewery

135 Main Street, North Woodstock NH 03262

Contact Person: Paulette Melanson, 603-226-4789

Beers & Peers, Burlington VT

It's time for some Beers with your Peers in Burlington VT.

Thursday, April 26, 2018, 5-8:00 PM

Location TBA

Contact Person: Paulette Melanson, 603-226-4789

2018 "Swing Into Spring" Golf Tournament

Network and develop business while enjoying a day of golf!

Friday, May 11, 2018, 8:00 AM

Breakfast Hill Golf Club

339 Breakfast Hill Rd., Greenland, NH 03840

8:00 AM Registration

9:00 AM Shotgun Start

3:00 PM Awards & Club House Reception

Contact Person: Paulette Melanson, 603-226-4789



Start **Saving** Today

abc.org/discounts

Companies can take advantage of these great programs!



Provided by Fringe Benefit Group

Setup fees are waived on this total benefits solution of ACA-compliant benefits and retirement plans.

AIA Contract Documents
THE INDUSTRY STANDARD

payroll4construction.com



Save up to 29 percent on shipping services.

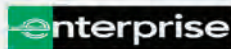

FLEET MANAGEMENT

Reduce your vehicle fleet management costs and gain access to all incentives.



FORD FLEET



Premium pricing on professional development and leadership training courses.



Receive discounts and a free Executive Dashboard with a new construction accounting software purchase – a \$1,595 value.



Exclusive discounts on Autodesk products (e.g., AutoCAD, Revit, Civil 3D), and software on scheduling, document control, data management and laser scanning.



ExxonMobil Brands

Companies **and their employees** can take advantage of these great programs!



Exclusive pricing from thousands of merchants on everyday purchases.



FIAT CHRYSLER AUTOMOBILES

Members and their immediate family members receive discounts on most Chrysler, Dodge, Jeep®, RAM® and Fiat® vehicles.



Contractors and building material suppliers are eligible for a 22 percent discount on calling plans, and savings on mobile devices.



Save 20 percent on uniform rentals and purchases of work and safety apparel, logo'd apparel, boots and more.



Exclusive discounts on Ramada, Days Inn, Super 8, Baymont and other affordable brands.

For complete details visit abc.org/discounts



Construction is a great career path with limitless possibilities

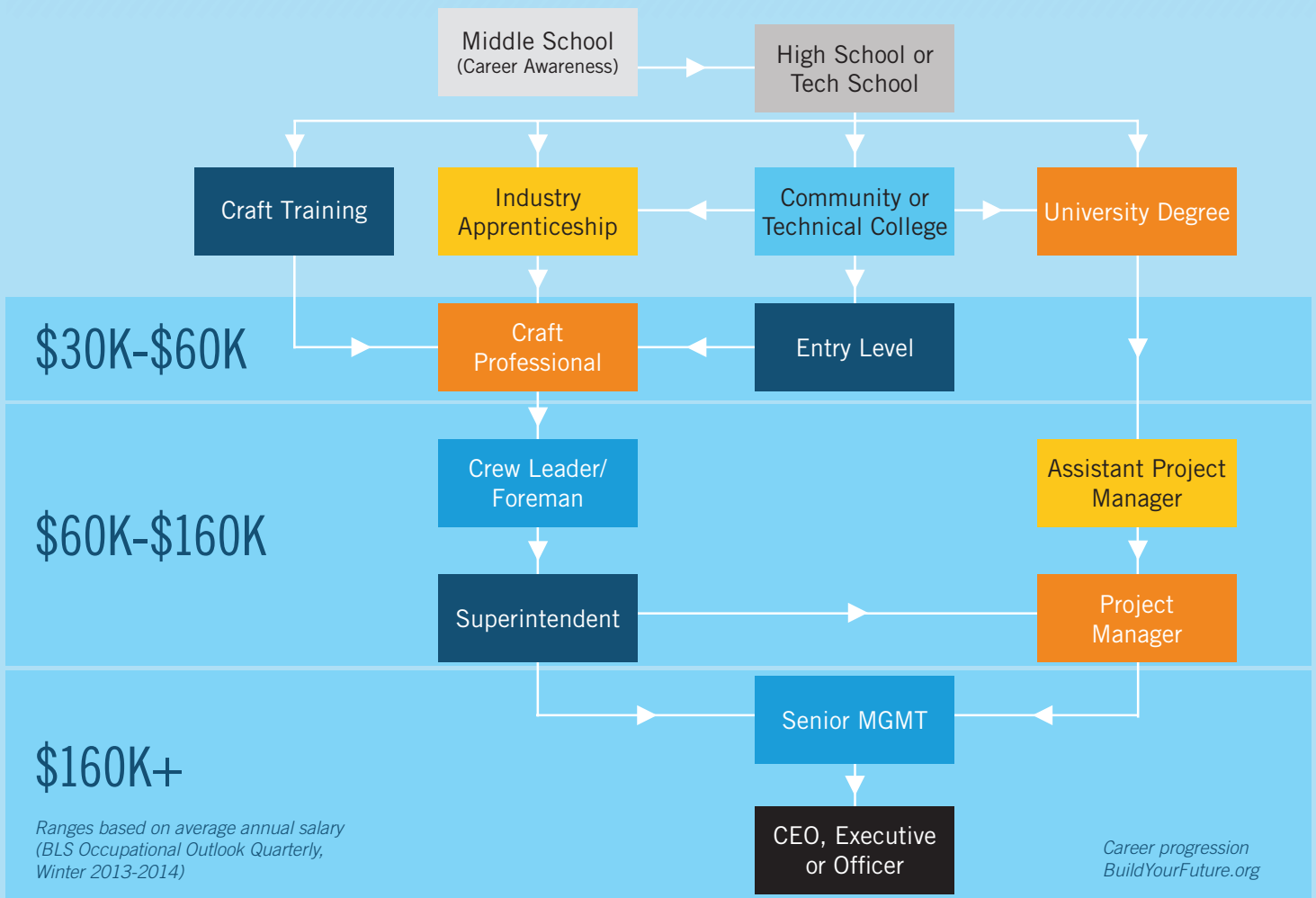

The construction industry is rapidly growing...

Employment will grow at an annual rate of

2.6%

Tied with the health care sector for the **fastest growth** over the next decade.



5 of the 30 occupations projected to experience the largest employment increase between 2012-2022 are related to construction.

Occupations typically requiring apprenticeship training are projected to grow

22.2%
from 2012-2022.

2X

More than twice as fast as the average of all industries.

US Department of Labor's 2013 Occupational Outlook Handbook

workforceunderconstruction.com
abc.org

